

Shaker-inspired Step Stool

Pocket screws serve as clamps for panel glue-up.

Inspired by a typical Shaker step stool, this version employs pocket screws to join both the side panels and the supports. To cut down on the number of rip cuts, I used three pieces of 1x6 dimensional lumber to form the side panels (1x6 actually measures $\frac{3}{4}$ " x $5\frac{1}{2}$ "), so this version also ends up a bit deeper than a traditional Shaker stool – and thus a little sturdier and beefier looking.

First, use your miter saw to cut the 1x6 pieces to length for the side panels. You'll need two each at $20\frac{1}{4}$ ", $13\frac{1}{4}$ " and $6\frac{1}{4}$ ".

Now, clamp one of the $20\frac{1}{4}$ " pieces flat to your bench (face side down), and drill holes for two pocket screws along the edge that will meet the middle piece. Place one hole 2" from the bottom edge, the other at 11". Repeat with the second $20\frac{1}{4}$ " piece. Now drill each $13\frac{1}{4}$ " piece along the edges that will meet the short pieces. Locate one hole 3" from the bottom edge, the other at $5\frac{1}{4}$ ".

Next, it's time to glue up the side panels, and this is where the pocket screws come in

Shaker-inspired step stool. Don't let the panel glue-up scare you. This step stool (useful in just about any room of the house) is easy to build, using pocket screws as clamps and to add strength.

handy – especially if you're short on clamps. Run a bead of wood glue along the edge of one of the $6\frac{1}{4}$ " pieces, then line up that piece and a $13\frac{1}{4}$ " piece flush across the bottom, and flat across the panel, then clamp across the two. Drive screws into the pockets to join the two pieces together. Now that the screws are in place, you can unclamp and move on to joining the $20\frac{1}{4}$ " to the $13\frac{1}{4}$ " piece. Do the same with the other side panel.

Once your glue is dry, lay the panel screw-

Drill the side panels. To use pocket screws to assist with panel glue-up, clamp the side pieces flat to your bench, and drill pocket holes to join the panel pieces. Here, I'm drilling the middle board with one hole 3" up from the bottom edge (it will get cut away when you cut the arc) and another hole $5\frac{1}{4}$ " from the bottom edge.

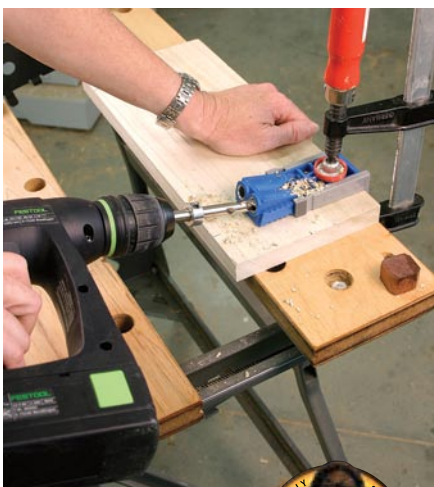

Online EXTRAS

For a slide show of how this project is assembled, go to:

popularwoodworking.com/nov07

side up flat on your bench, and mark the center point across the bottom edge (it should be at $8\frac{1}{4}$ "). Now, using an offcut as the base for the compass point, measure 2" down from the center point, place the compass point there, and draw the arc. Use a jigsaw to cut out the arc (you'll be cutting away the two bottom screws), then clean up the cut using a rasp and sandpaper.

Use a miter saw to cut the three step supports and back brace to $15\frac{3}{4}$ " out of 1x2 (which actually measures $\frac{3}{4}$ " x $1\frac{1}{2}$ "). Clamp

This plan brought to you by:



Published in Popular Woodworking Magazine.
www.popularwoodworking.com

Shaker-inspired Step Stool

NO.	ITEM	DIMENSIONS (INCHES)			MATERIAL
		T	W	L	
□ 2	Long panel piece	3/4	5 1/2	20 1/4	Poplar
□ 2	Middle panel piece	3/4	5 1/2	13 1/4	Poplar
□ 2	Short panel piece	3/4	5 1/2	6 1/4	Poplar
□ 3	Step support	3/4	1 1/2	15 3/4	Poplar
□ 1	Back brace	3/4	1 1/2	15 3/4	Poplar
□ 3	Treads	3/4	5 7/8	18 1/4	Poplar



Panel glue-up. Use a clamp to hold your panel pieces together as you seat the pocket screws. Once the screws are in place, the clamp can be removed.

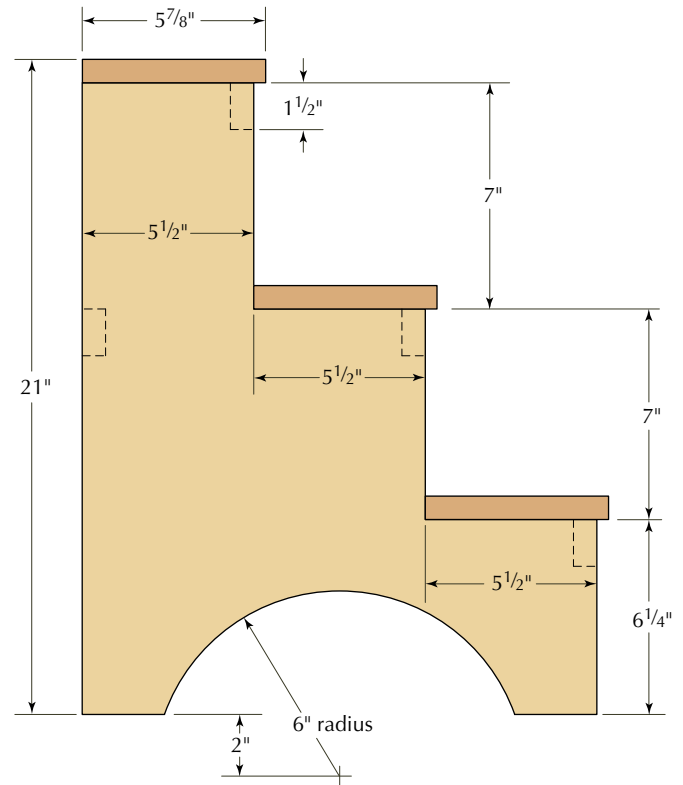

PROFILE

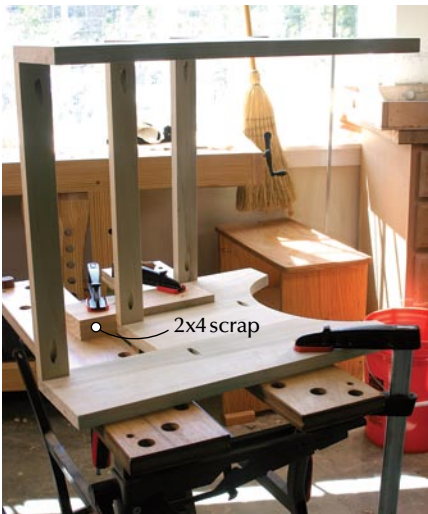

Quick and easy screwing jig. A scrap of 2x4 is clamped to the Workmate to serve as a guide and support for screwing the step supports and back brace in place on the side panels.

each piece flat and drill one pocket hole into the center at either end. Set them aside.

Now, out of 1x8 (actually 3/4" x 7 1/2"), cut the three step treads to their final length of 18 1/4", then clamp a piece flat to your bench, with one long edge overhanging. Use your jig-saw to rip each tread to a width of 5 7/8". (You'll get a straighter cut if you clamp a straightedge

in place to guide the foot of the jigsaw.)

Now all the pieces are ready for assembly; this is a good time to sand (because as yet there are no corners to deal with). Sand over the panel joints to ensure the panels are flat. If you're planning to paint, sand to #120; if staining, you may want to sand to #180.

Joining the step supports and back brace to the sides is a bit tricky, involving some creative clamping and a scrap of 2x4. Separate the two halves of your Workmate so you can get clamps through the middle, then clamp the 2x4 scrap tight to the table. Butt the front edge of the bottom riser (the short piece in the panel) flush to the 2x4, and clamp the panel to the table. Hold the step support against the 2x4 flush with the top of the riser, gripping firmly to keep it aligned, then drive the screw into the pocket to join the support to the panel (see picture at left). Reclamp the panel against the 2x4 to attach the center and top step supports, as well as the back brace.

Now attach the second side panel, using the same screwing jig. (If your drill is large, borrow a small one—or use a screwdriver—to more easily get inside the workpiece.)

Center each tread across the steps, drill pilot holes, then nail the treads in place with #6 finish nails. Use a nailset to sink the nails

below the tread surface, then fill the holes with wood filler (or spackle), and let it dry.

Once the filler is dry, sand the joint edges and filler flush. Chamfer the front and side edges of the treads with a block plane to keep them from splintering, and break the back edge with sandpaper. Paint or stain as desired. **PW**

Comments or a question? Contact Megan at 513-531-2690 x1348 or megan.fitzpatrick@fwpubs.com.

About This Column

Our "I Can Do That" column features projects that can be completed by any woodworker with a modest (but decent) kit of tools in less than two days of shop time, and using raw materials that are available at any home center. We offer a free online manual in PDF format that explains all the tools and shows you how to perform the basic operations in a step-by-step format. You'll learn to rip with a jigsaw, crosscut with a miter saw and drill straight with the help of our manual.



Visit ICanDoThatExtras.com to download the free manual.